

No.	DATE	REVISIONS	BY
1	7-20-16	PER NYS DOT COMMENTS	TN/DW
2	2-09-17	PER NYS DOT COMMENTS	PG
3	7-22-17	PER NYS DOT COMMENTS	EB/PG
4	8-08-17	PER NYS DOT COMMENTS	EB/PG
5	8-22-17	PER NYS DOT COMMENTS	PG/PG
6	9-13-17	PER O&R UTILITY POLE LAYOUT	PG/PG

Dig Safely. New York
 Call Before You Dig
 Wait the Required Time
 Confirm Utility Response
 Respect the Marks
 Dig with Care
800-962-7962
 www.digsafelynewyork.com

PROJECT No.:	AJ14184
DRAWN BY:	TN
CHECKED BY:	PG
DATE:	7-30-2015
SCALE:	1" = 30'
CAD I.D.:	AJ14184-TCP

PROJECT: INTERSECTION IMPROVEMENT PLANS FOR CITY OF MIDDLETOWN
 PROPOSED ROUNDABOUT PIN 875699
 MIDDLETOWN BYPASS (C.R. 78) & JAMES P. KELLY WAY (C.R. 108)
 CITY OF MIDDLETOWN
 ORANGE COUNTY, NY

APPROVED FOR CONSTRUCTION

ATLANTIC TRAFFIC & DESIGN ENGINEERS, INC.
 35 Technology Drive
 Warren, New Jersey 07059
 Phone: (908) 769-5588
 Fax: (908) 769-7733
 New York State Certificate of Authorization No. 76264

PAUL B. GOING
 PROFESSIONAL ENGINEER
 NEW YORK LICENSE NO. 76261

SHEET TITLE: **WZTC PLAN PHASE II (1 OF 2)**

SHEET NUMBER: **37 OF 41**

REVISION 6 9-13-2017

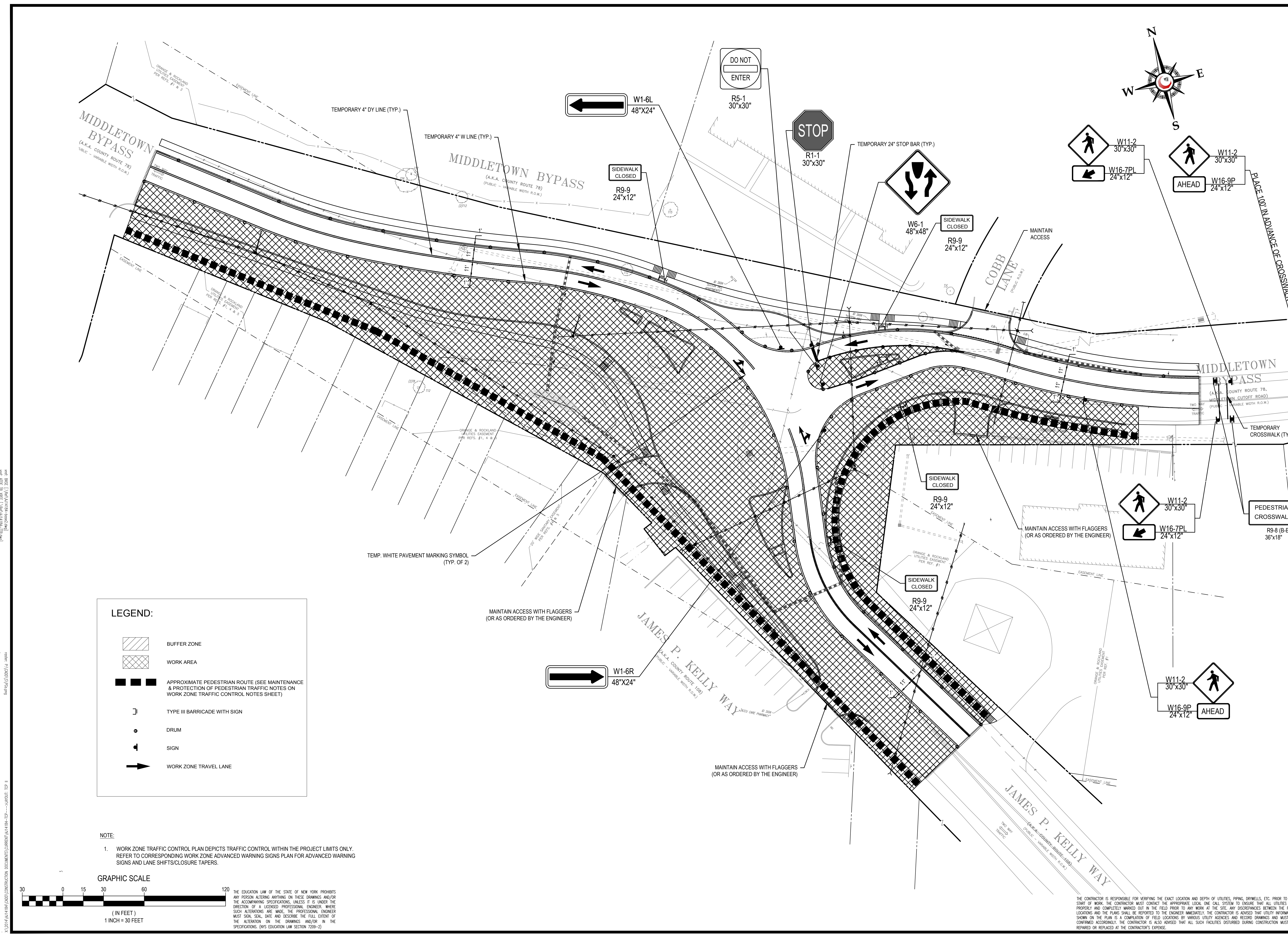

LEGEND:

- BUFFER ZONE
- WORK AREA
- APPROXIMATE PEDESTRIAN ROUTE (SEE MAINTENANCE & PROTECTION OF PEDESTRIAN TRAFFIC NOTES ON WORK ZONE TRAFFIC CONTROL NOTES SHEET)
- TYPE III BARRICADE WITH SIGN
- DRUM
- SIGN
- WORK ZONE TRAVEL LANE

NOTE:
 1. WORK ZONE TRAFFIC CONTROL PLAN DEPICTS TRAFFIC CONTROL WITHIN THE PROJECT LIMITS ONLY. REFER TO CORRESPONDING WORK ZONE ADVANCED WARNING SIGNS PLAN FOR ADVANCED WARNING SIGNS AND LANE SHIFTS/CLOSURE TAPERS.

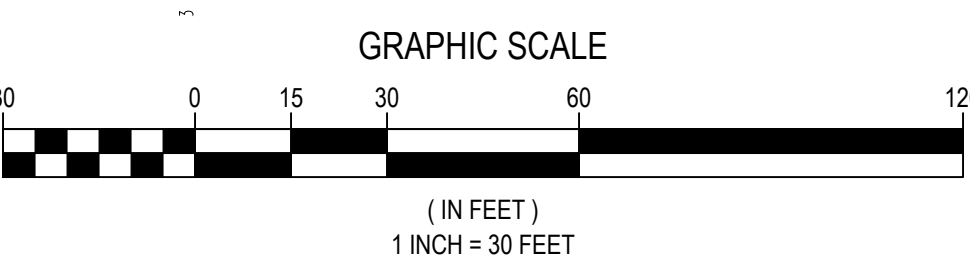

THE EDUCATION LAW OF THE STATE OF NEW YORK PROHIBITS ANY PERSON ALTERING ANYTHING ON THESE DRAWINGS AND/OR THE ACCOMPANYING SPECIFICATIONS, UNLESS IT IS UNDER THE DIRECTION OF A LICENSED PROFESSIONAL ENGINEER, WHERE SUCH ALTERATIONS ARE MADE. THE PROFESSIONAL ENGINEER MUST SIGN, SEAL, DATE AND DESCRIBE THE FULL EXTENT OF THE ALTERATION ON THE DRAWINGS AND/OR IN THE SPECIFICATIONS. (NYS EDUCATION LAW SECTION 2209-2)

PLANNING AND DESIGN CONSULTANTS
 NEW YORK STATE LICENSE NO. 76264
 PROJECT: INTERSECTION IMPROVEMENT PLANS FOR CITY OF MIDDLETOWN
 PROJECT NO. AJ14184
 SHEET TITLE: WZTC PLAN PHASE II (1 OF 2)
 SHEET NUMBER: 37 OF 41
 DATE: 7-30-2015
 SCALE: 1" = 30'
 DRAWN BY: TN
 CHECKED BY: PG
 PROJECT LOCATION: MIDDLETOWN BYPASS (C.R. 78) & JAMES P. KELLY WAY (C.R. 108)
 CITY OF MIDDLETOWN, ORANGE COUNTY, NY
 PROJECT PIN: 875699
 PROJECT DESCRIPTION: PROPOSED ROUNDABOUT
 PROJECT PHASE: PHASE II
 PROJECT STATUS: APPROVED FOR CONSTRUCTION
 PROJECT OWNER: CITY OF MIDDLETOWN
 PROJECT CONTACT: [REDACTED]
 PROJECT ADDRESS: [REDACTED]
 PROJECT PHONE: [REDACTED]
 PROJECT FAX: [REDACTED]
 PROJECT EMAIL: [REDACTED]
 PROJECT WEBSITE: [REDACTED]
 PROJECT URL: [REDACTED]
 PROJECT MAP: [REDACTED]
 PROJECT AERIAL: [REDACTED]
 PROJECT PHOTO: [REDACTED]
 PROJECT VIDEO: [REDACTED]
 PROJECT DOCUMENTS: [REDACTED]
 PROJECT DRAWINGS: [REDACTED]
 PROJECT SPECIFICATIONS: [REDACTED]
 PROJECT CONTRACTS: [REDACTED]
 PROJECT AGREEMENTS: [REDACTED]
 PROJECT PERMITS: [REDACTED]
 PROJECT UTILITIES: [REDACTED]
 PROJECT SURVEYING: [REDACTED]
 PROJECT ENGINEERING: [REDACTED]
 PROJECT ARCHITECTURE: [REDACTED]
 PROJECT INTERIORS: [REDACTED]
 PROJECT LANDSCAPE: [REDACTED]
 PROJECT CIVIL: [REDACTED]
 PROJECT MECHANICAL: [REDACTED]
 PROJECT ELECTRICAL: [REDACTED]
 PROJECT PLUMBING: [REDACTED]
 PROJECT HEATING: [REDACTED]
 PROJECT COOLING: [REDACTED]
 PROJECT SOUND: [REDACTED]
 PROJECT VIBRATION: [REDACTED]
 PROJECT AIR QUALITY: [REDACTED]
 PROJECT WATER: [REDACTED]
 PROJECT SEWER: [REDACTED]
 PROJECT WASTE: [REDACTED]
 PROJECT ENERGY: [REDACTED]
 PROJECT SAFETY: [REDACTED]
 PROJECT SECURITY: [REDACTED]
 PROJECT ACCESSIBILITY: [REDACTED]
 PROJECT HISTORIC: [REDACTED]
 PROJECT ENVIRONMENTAL: [REDACTED]
 PROJECT ARCHAEOLOGICAL: [REDACTED]
 PROJECT PALEONTOLOGICAL: [REDACTED]
 PROJECT HISTORIC ARCHITECTURE: [REDACTED]
 PROJECT HISTORIC LANDMARKS: [REDACTED]
 PROJECT HISTORIC DISTRICTS: [REDACTED]
 PROJECT HISTORIC MONUMENTS: [REDACTED]
 PROJECT HISTORIC STRUCTURES: [REDACTED]
 PROJECT HISTORIC OBJECTS: [REDACTED]
 PROJECT HISTORIC PLACES: [REDACTED]
 PROJECT HISTORIC SITES: [REDACTED]
 PROJECT HISTORIC AREAS: [REDACTED]
 PROJECT HISTORIC ZONES: [REDACTED]
 PROJECT HISTORIC DISTRICTS: [REDACTED]
 PROJECT HISTORIC MONUMENTS: [REDACTED]
 PROJECT HISTORIC STRUCTURES: [REDACTED]
 PROJECT HISTORIC OBJECTS: [REDACTED]
 PROJECT HISTORIC PLACES: [REDACTED]
 PROJECT HISTORIC SITES: [REDACTED]
 PROJECT HISTORIC AREAS: [REDACTED]
 PROJECT HISTORIC ZONES: [REDACTED]